

# DRYWALL SANDER

## User Manual

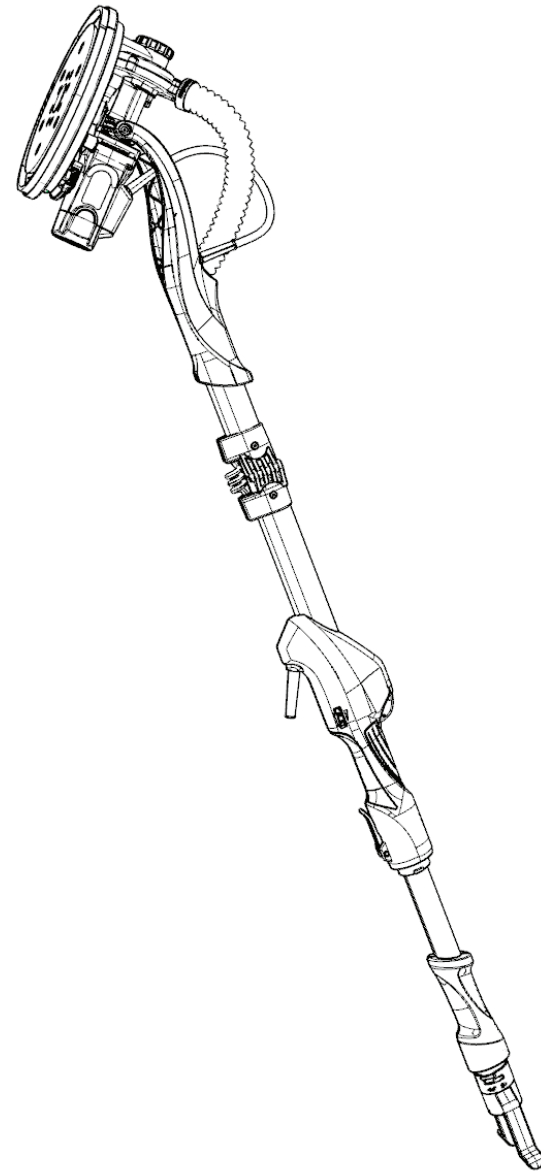

### Questions?

Don't hesitate to drop a message at [support@inokraft.com](mailto:support@inokraft.com)!

Join InoKraft Community for

**INSTRUCTION VIDEOS**  
**FREE ACCESSORIES**  
**FREE TRIALS OF NEW PRODUCTS**  
**EXTENDED WARRANTY**

by sending "I'm a craftsman" and your **purchase order ID** to [support@inokraft.com](mailto:support@inokraft.com) or Scan:



Official Youtube  
[www.youtube.com/@inokraft](http://www.youtube.com/@inokraft)

**INOKRAFT**

## CONTENTS

<b>SYMBOLS</b>	1
<b>SAFETY</b>	2
<b>INTRODUCTION</b>	8
<b>PRODUCT INFORMATION</b>	8
<b>TECHNICAL DATA</b>	8
<b>ASSEMBLY</b>	10
<b>GRIT SELECTION GUIDE</b>	10
<b>SANDING</b>	11
<b>SANDING PAD REPLACEMENT</b>	12
<b>CARBON BRUSH REPLACEMENT</b>	12
<b>MAINTENANCE</b>	13
<b>TROUBLE SHOOTING</b>	13
<b>WARRANTY</b>	15

## SYMBOLS

On the product, the rating label and within these instructions you will find among others the following symbols and abbreviations. Familiarize yourself with them to reduce hazards like personal injuries and damage to property.

V~	Volt, (alternating voltage)	mm	Millimetre
Hz	Hertz	kg	Kilogram
W	Watt	dB(A)	Decibel (A-rated)
/min or min <sup>-1</sup>	Per minute	m/s <sup>2</sup>	Metres per seconds squared



Lock / to tighten or secure.



Unlock / to loosen.



Note / Remark.



Caution / Warning.



Read the instruction manual.



Wear hearing protection.



Wear eye protection.



Wear a dust mask.



Wear protective gloves.



Wear protective, slip-resistant footwear.



Switch the product off and disconnect it from the power supply before assembly, cleaning, adjustments, maintenance, storage and transportation.



This product is of protection class II. That means it is equipped with enhanced or double insulation.



The product complies with the applicable European directives and an evaluation method of conformity for these directives was done.



WEEE symbol. Waste electrical products should not be disposed of with household waste. Please recycle where facilities exist. Check with your Local Authority or local store for recycling advice.

# SAFETY

## GENERAL SAFETY INSTRUCTIONS



**WARNING!** Read all safety warnings and all instructions. Failure to follow the warnings and instructions may result in electric shock, fire and/or serious injury. Save all warnings and instructions for future reference. The term “power tool” in the warnings refers to your mainsoperated (corded) power tool or battery-operated (cordless) power tool.

### 1.WORK AREA SAFETY

- > Keep work area clean and well lit. Cluttered or dark areas invite accidents.
- > Do not operate power tools in explosive atmospheres, such as in the presence of flammable liquids, gases or dust. Power tools create sparks which may ignite the dust or fumes.
- > Keep children and bystanders away while operating a power tool. Distractions can cause you to lose control.

### 2.ELECTRICAL SAFETY

- > Power tool plugs must match the outlet. Never modify the plug in any way. Do not use any adapter plugs with earthed (grounded) power tools.Unmodified plugs and matching outlets will reduce risk of electric shock.
- > Avoid body contact with earthed or grounded surfaces such as pipes, radiators, ranges and refrigerators. There is an increased risk of electric shock if your body is earthed or grounded.
- > Do not expose power tools to rain or wet conditions.Water entering a power tool will increase the risk of electric shock.
- > Do not abuse the cord. Never use the cord for carrying, pulling or unplugging the power tool. Keep cord away from heat, oil, sharp edges or moving parts. Damaged or entangled cords increase the risk of electric shock.
- > When operating a power tool outdoors, use an extension cord suitable for outdoor use. Use of a cord suitable for outdoor use reduces the risk of electric shock.

- > If operating a power tool in a damp location is unavoidable, use an earth leakage circuit breaker. Use of an earth leakage circuit breaker reduces the risk of electric shock.

### 3.PERSONAL SAFETY

- > Stay alert, watch what you are doing and use common sense when operating a power tool. Do not use a power tool while you are tired or under the influence of drugs, alcohol or medication. A moment of inattention while operating power tools may result in serious personal injury.
- > Use personal protective equipment. Always wear eye protection. Protective equipment such as dust mask, non-skid safety shoes, hard hat, or hearing protection used for appropriate conditions will reduce personal injuries.
- > Prevent unintentional starting. Ensure the switch is in the off-position before connecting to power source and/or battery pack, picking up or carrying the tool. Carrying power tools with your finger on the switch or energising power tools that have the switch on invites accidents.
- > Remove any adjusting key or wrench before turning the power tool on. A wrench or a key left attached to a rotating part of the power tool may result in personal injury.
- > Do not overreach. Keep proper footing and balance at all times. This enables better control of the power tool in unexpected situations.
- > Dress properly. Do not wear loose clothing or jewelry. Keep your hair, clothing and gloves away from moving parts. Loose clothes, jewelry or long hair can be caught in moving parts.
- > If devices are provided for the connection of dust extraction and collection facilities, ensure these are connected and properly used. Use of dust collection can reduce dust-related hazards.

### 4. POWER TOOL USE AND CARE

- > Do not force the power tool. Use the correct power tool for your application. The correct power tool will do the job better and safer at the rate for which it was designed.
- > Do not use the power tool if the switch does not turn it on and off. Any power tool that cannot be controlled with the switch is dangerous and must be repaired.
- > Disconnect the plug from the power source and/or the battery pack from the power tool before making any adjustments, changing accessories, or storing power tools. Such preventive safety measures reduce the risk of starting the power tool accidentally.
- > Store idle power tools out of the reach of children and do not allow persons unfamiliar with the power tool or these instructions to operate the power tool. Power tools are dangerous in the hands of untrained users.

- > Maintain power tools. Check for misalignment or binding of moving parts, breakage of parts and any other condition that may affect the power tool's operation. If damaged, have the power tool repaired before use. Many accidents are caused by poorly maintained power tools.
- > Keep cutting tools sharp and clean. Properly maintained cutting tools with sharp cutting edges are less likely to bind and are easier to control.
- > Use the power tool, accessories and tool bits etc., in accordance with these instructions, taking into account the working conditions and the work to be performed. Use of the power tool for operations different from those intended could result in a hazardous situation.

## 5.SERVICE

- > Have your power tool serviced by a qualified repair person using only identical replacement parts. This will ensure that the safety of the power tool is maintained.

## SAFETY INSTRUCTIONS FOR POLISHERS

### 1) SAFETY INSTRUCTIONS FOR ALL OPERATIONS

- a) This power tool is intended to function as a polisher. Read all safety warnings, instructions, illustrations and specifications provided with this power tool. Failure to follow all instructions listed below may result in electric shock, fire and/or serious injury.
- b) This power tool is not recommended for grinding, sanding, wire brushing or cutting off operations. Operations for which the power tool was not designed may create a hazard and cause personal injury.
- c) Do not use accessories which are not specifically designed and recommended by the tool manufacturer. Just because the accessory can be attached to your power tool, it does not assure safe operation.
- d) The rated speed of the accessory must be at least equal to the maximum speed marked on the power tool. Accessories running faster than their rated speed can fly apart.
- e) The outside diameter and the thickness of your accessory must be within the capacity rating of your power tool. Incorrectly sized accessories cannot be adequately guarded or controlled.
- f) The arbour size of wheels, flanges, backing pads or any other accessory must properly fit the spindle of the power tool. Accessories with arbour holes that do not match the mounting hardware of the power tool will run out of balance, vibrate excessively and may cause loss of control.
- g) Do not use a damaged accessory. Before each use inspect the accessory such as abrasive wheels for chips and cracks, backing pads for cracks, tear or excess wear, wire brushes for loose or cracked wires. If the power tool or accessory is dropped, inspect for damage or install an undamaged accessory. After inspecting and installing an accessory, position yourself and bystanders away from the plane of the rotating accessory and run the power tool at maximum no load speed for one minute. Damaged accessories will normally break apart during this test time.

- h) Wear personal protective equipment. Depending on application, use face shield, safety goggles or safety glasses. As appropriate, wear dust mask, hearing protectors, gloves and shop apron capable of stopping small abrasive or workpiece fragments. The eye protection must be capable of stopping flying debris generated by various operations. The dust mask or respirator must be capable of filtering particles generated by your operation. Prolonged exposure to high intensity noise may cause hearing loss.
- i) Keep bystanders a safe distance away from work area. Anyone entering the work area must wear personal protective equipment. Fragments of the workpiece or of a broken accessory may fly away and cause injury beyond the immediate area of operation.
- j) Hold power tool by insulated gripping surfaces only, when performing an operation where the cutting accessory may contact hidden wiring or its own cord. A cutting accessory contacting a "live" wire may make exposed metal parts of the power tool "live" and could give the operator an electric shock.
- k) Position the cord clear of the spinning accessory. If you lose control, the cord may be cut or snagged and your hand or arm may be pulled into the spinning accessory.
- l) Never lay the power tool down until the accessory has come to a complete stop. The spinning accessory may grab the surface and pull the power tool out of your control.
- m) Do not run the power tool while carrying it at your side. Accidental contact with the spinning accessory could snag your clothing, pulling the accessory into your body.
- n) Regularly clean the power tool's air vents. The motor's fan will draw the dust inside the housing and excessive accumulation of powdered metal may cause electrical hazards.
- o) Do not operate the power tool near flammable materials. Sparks could ignite these materials.
- p) Do not use accessories that require liquid coolants. Using water or other liquid coolants may result in electrocution or shock.

### 2) KICKBACK AND RELATED WARNINGS

- Kickback is a sudden reaction to a pinched or snagged rotating wheel, backing pad, brush or any other accessory. Pinching or snagging causes rapid stalling of the rotating accessory which in turn causes the uncontrolled power tool to be forced in the direction opposite of the accessory's rotation at the point of the binding.

- For example, if an abrasive wheel is snagged or pinched by the workpiece, the edge of the wheel that is entering into the pinch point can dig into the surface of the material causing the wheel to climb out or kick out. The wheel may either jump toward or away from the operator, depending on the direction of the wheel's movement at the point of pinching. Abrasive wheels may also break under these conditions.
- Kickback is the result of power tool misuse and/or incorrect operating procedures or conditions and can be avoided by taking proper precautions as given below.
  - a) Maintain a firm grip on the power tool and position your body and arm to allow you to resist kickback forces. Always use auxiliary handle, if provided, for maximum control over kickback or torque reaction during start-up. The operator can control torque reactions or kickback forces, if proper precautions are taken.
  - b) Never place your hand near the rotating accessory. The accessory may kickback over your hand.
  - c) Do not position your body in the area where power tool will move if kickback occurs. Kickback will propel the tool in the direction opposite to the wheel's movement at the point of snagging.
  - d) Use special care when working corners, sharp edges etc. Avoid bouncing and snagging the accessory. Corners, sharp edges or bouncing have a tendency to snag the rotating accessory and cause loss of control or kickback.
  - e) Do not attach a saw chain woodcarving blade or toothed saw blade. Such blades create frequent kickback and loss of control.

## GENERAL

- This tool should not be used by people under the age of 16 years
- This tool is not intended for use by persons (including children) with reduced physical, sensory or mental capabilities, or lack of experience and knowledge, unless they have been given supervision or instruction concerning use of the tool by a person responsible for their safety
- Ensure that children do not play with the tool
- This tool is not suitable for wet sanding
- **Always disconnect plug from power source before making any adjustment or changing any accessory**

## BEFORE USE

- Before using the tool for the first time, it is recommended to receive practical information
- Always check that the supply voltage is the same as the voltage indicated on the nameplate of the tool (tools with a rating of 230V or 240V can also be connected to a 220V supply)
- **Use suitable detectors to find hidden utility lines or call the local utility company for assistance**(contact with electric lines can lead to fire or electrical shock; damaging a gas line can result in an explosion; penetrating a water pipe will cause property damage or an electrical shock)
- **Do not work materials containing asbestos** (asbestos is considered carcinogenic)
- Dust from material such as paint containing lead, some wood species, minerals and metal may be harmful (contact with or inhalation of the dust may cause allergic reactions and/or respiratory diseases to the operator or bystanders); **wear a dust mask and work with a dust extraction device when connectable**
- Certain kinds of dust are classified as carcinogenic (such as oak and beech dust) especially in conjunction with additives for wood conditioning; **wear a dust mask and work with a dust extraction device when connectable**
- Follow the dust-related national requirements for the materials you want to work with
- Do not clamp the tool in a vice
- Use completely unrolled and safe extension cords with a capacity of 16 Amps (U.K. 13 Amps)

## AFTER USE

- After switching off the tool, never stop the rotation of the accessory by a lateral force applied against it

## USE

### Replace sanding pad②

- Insert the hex wrench R (size 5) into the hexagonal screw bolt on the sanding block
- Hold the sanding pad firmly, and then turn the wrench counter clockwise to dismount the pad.
- Install new sanding pad by tightening the bolt.

## INTRODUCTION

The InoKraft drywall sander is specifically designed for efficient sanding of large wall surfaces. It features excellent dust extraction capabilities with its built-in vacuum function and also supports connection to a separate vacuum cleaner, reducing dust during the sanding process. This kit includes essential sanding accessories and a user manual to facilitate easy and quick operation. Primary wall surface types suitable for sanding:

- Drywall
- Textured ceilings (excluding popcorn ceilings containing asbestos)
- Walls with surface patterns
- Wall repair areas
- ⚠ Sanding popcorn ceilings that contain asbestos or paint with lead is not recommended.

## PRODUCT INFORMATION

### Drywall sander kit

1. Drywall sander \*1
2. Extension pole (65 inch) \*1
3. Vacuum hose \*1 \*
4. Dust collection bag \*1 \*
5. Vacuum hose adapter (35mm) \*1
6. Vacuum hose adapter (47mm) \*1
7. 1-7/8" & 2-1/2" vacuum cleaner adapter \*1 \*
8. Protective connector
9. Mesh sanding discs set (80-120-180-240 grit) \*1 \*
10. Safety goggles \*1
11. Shoulder strap system \*1
12. Hex wrench \*1
13. Elastic band \*1
14. O-rings \*2
15. User manual \*1
16. Quick start guide \*1
17. Storage bag \*1

The accessories and consumables marked with an asterisk (\*) can be purchased by searching for "InoKraft drywall sander" on Amazon or by contacting customer support at [support@inokraft.com](mailto:support@inokraft.com).

## TECHNICAL DATA

<b>Rated voltage, frequency</b>	120V-,60Hz	
<b>Rated power input</b>	820W	6.5A
<b>Rotation Speed</b>	600-1900 min <sup>-1</sup>	
<b>Round Sanding Pad Ø</b>	215mm	8.5inches
<b>Protection class</b>	II □	
<b>Weight</b>	approx.3.5kg	
<b>Sanding Motion</b>	Rotation	
<b>Self-suction power</b>	Y	

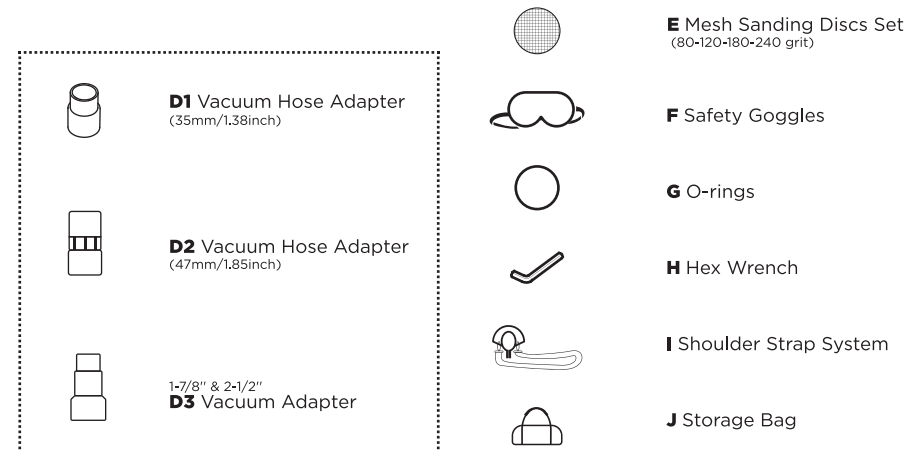
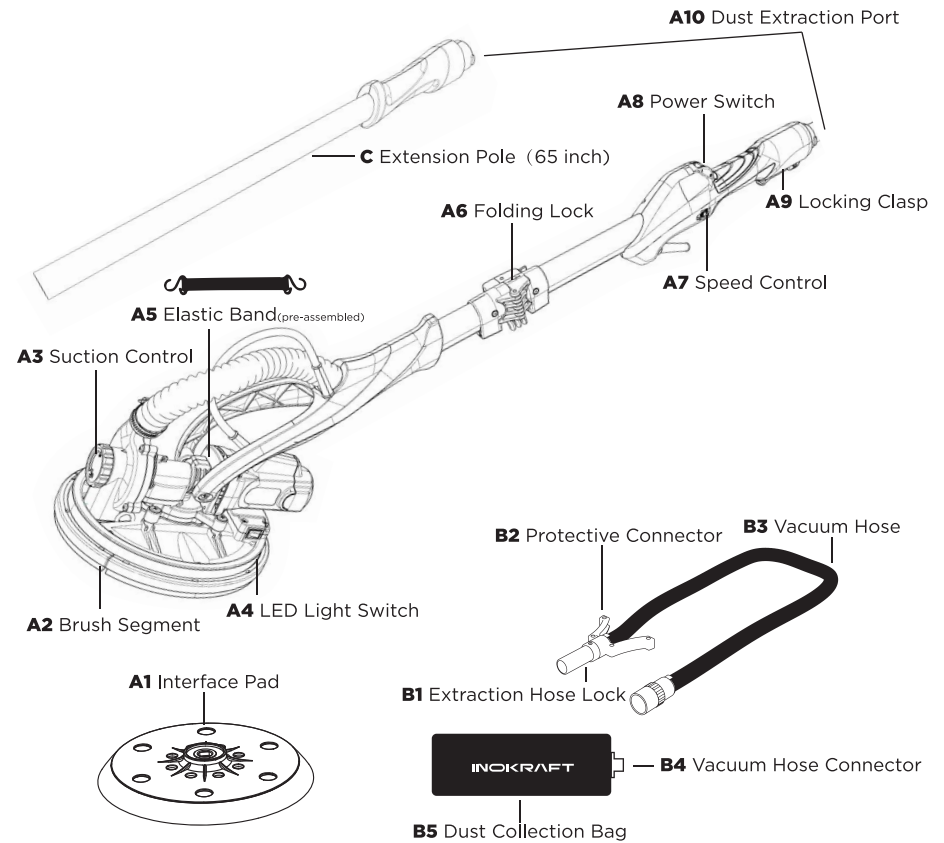

## ASSEMBLY

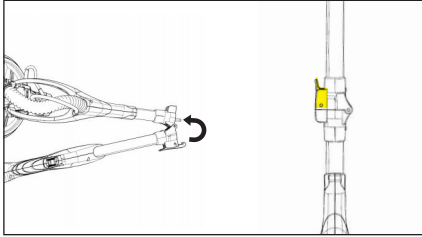

**1.** Unfold the handle and lock the folding lock (A6)

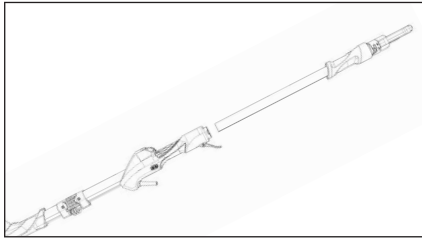

**2.** Install the extension pole (C) (optional) and lock the locking clasp (A9)

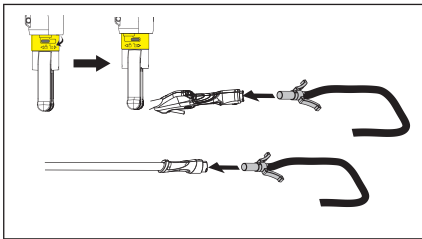

**3.** Connect the vacuum hose(B3) to the dust extraction port (A10) and rotate the extraction hose lock (B1)

**4.** Connection of vacuum system  
**Note: if you are sanding large areas with textured ceilings (eg. Popcorn ceilings), it is recommended to use an industrial-grade vacuum cleaner.**

- Dust collection bag(B5)  
Use only for light and small-area sanding.

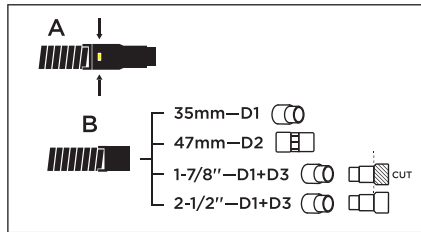

- Shop Vacuum

**A.** Remove the vacuum hose connector from the dust collection bag(B4).

**B.** Install the appropriate-sized connection accessory (D)

- Vacuum hose adapter (35mm) (D1)
- Vacuum hose adapter (47mm) (D2)
- If you need to connect 1-7/8", cut the vacuum cleaner adapter (D3) along the dotted line. Connect the small end to D1 and the large end to the vacuum cleaner hose.
- If you need to connect 2-1/2", connect the small end of the vacuum cleaner adapter (D3) to D1 and the large end to the vacuum cleaner hose.

**C.** Connect the shop vacuum hose interface.

**Note: For optimal dust extraction, please use an OSHA-compliant HEPA filter Dust Extractor and dust separator. Refer to the shop vacuum troubleshooting guide for any clogging issues.**

## GRIT SELECTION GUIDE

Observing the wall surface type, select the appropriate grit sanding disc based on the material, hardness, roughness, and surface texture. If you are unsure, start with a higher grit and adjust based on the sanding results.

**⚠ This sander is not suitable for wet surfaces or walls with a coated paint finish.**

### 80 Coarse

Removal  
Leveling and heavy stock or paint removal

### 100,120 Medium

Preparation  
Moderate stock removal & sanding preparation before paint

### 180 Fine

Finish  
Removing minor imperfections and initial sanding between paint/stain coats

### 220,320 Ultra Fine

Final Finish  
Final sanding and surface preparation for stain/varnish

**Tips: For optimal sanding results, please pair with InoKraft abrasives. Search InoKraft sanding disc for more info on Amazon.**

## SANDING

**1.** Attach the mesh sanding disc to the disc. If using a holed disc, ensure proper alignment with the holes.

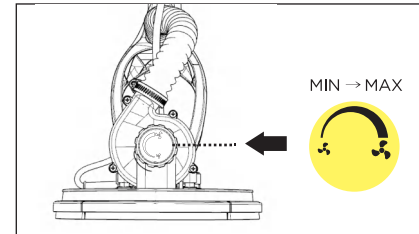

**2.** Adjust the suction power by rotating it to the right to the maximum setting (A3).

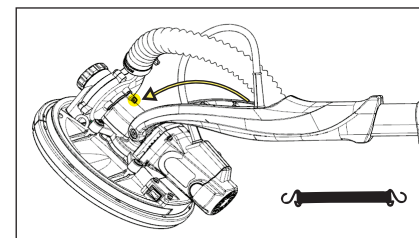

**3.** If sanding the ceiling, optionally install the elastic band (A5) to secure the position of the disc.

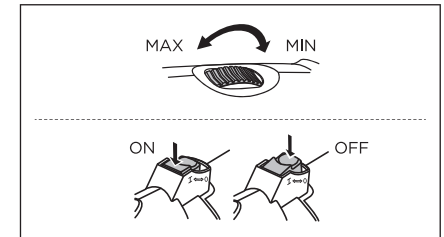

**4.** Set the speed(A7) to the minimum, plug in the power (120V/60Hz), turn on the LED light switch (A4) (optional), and turn on the power switch (A8).

**5.** Adjust the speed (A7) to start sanding at a medium-low speed. Adjust the speed based on the sanding results.

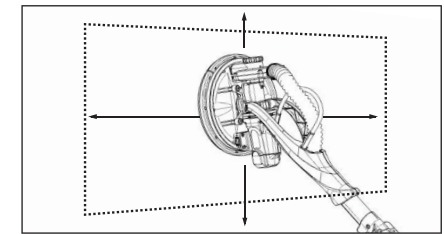

**6.** Gently place the sanding disc against the wall, keeping the sanding head parallel to the wall, and apply slight pressure. Sand back and forth in steady motion, either horizontally or vertically. Avoid applying excessive force, as it can result in gouged surface.

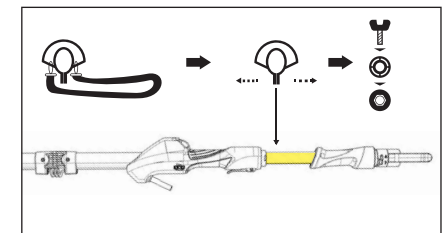

**7.** If you find the machine heavy during use, you can take breaks or use the shoulder strap system (I).

- A. Attach the clasp to the extension pole, insert the nut from ● to ○, then tighten it.
- B. Attach the shoulder strap to the clasp.
- C. Adjust the length of the shoulder strap based on your sanding position and height, aiming for a vertical force on the shoulder strap for optimal weight reduction.

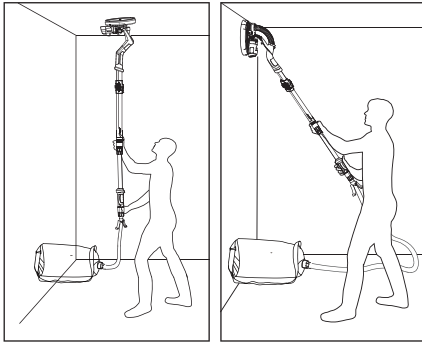

8. When stopping using the machine, turn off the power while moving to reduce dust fallout and prevent prolonged resting that could cause gouged surface. Allow the disc to come to a complete stop before placing it on the ground.

**For more information on the use and replacement of additional accessories and consumables, please refer to the user manual.**

## SANDING PAD REPLACEMENT

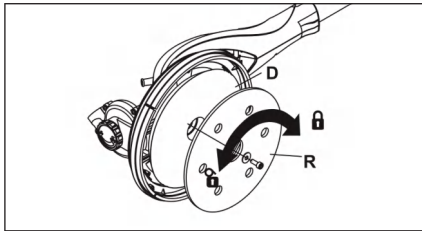

Please use the provided hex wrench to loosen the screw at the center of the disc. After reinstalling, make sure to tighten the screw securely and check the position of the sanding pad, ensuring it is below the level of the brush (within 2mm).

**Note: When replacing or installing the disc, be sure to turn off the power. Please use the InoKraft recommended sanding pad, as using other pads may affect performance and usability.**

## CARBON BRUSH(6×9×16MM) REPLACEMENT

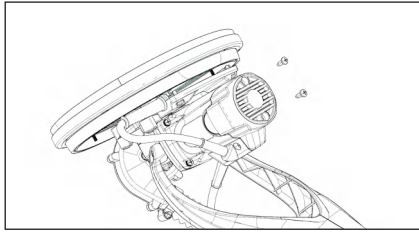

1. Use a screwdriver to loosen the rear cover screw.

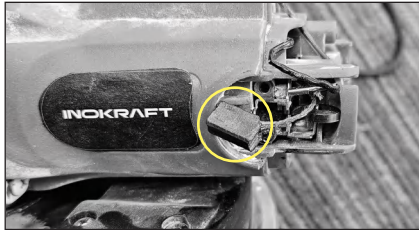

2. Remove the carbon block by pulling it out and disconnecting the connector.

3. Insert the new carbon block and secure it into the connector.

4. Close the rear cover and tighten the screw.

To purchase compatible carbon brushes, please visit Amazon and search for "InoKraft Carbon Brushes Replacement," or by contacting customer support at [support@inokraft.com](mailto:support@inokraft.com).

## MAINTENANCE

After each use, it is recommended to turn on the power and vacuum functions to let the machine run without sanding. This will help clear any residual dust inside and prevent the accumulation of damp dust that could lead to blockages. You can also use a dust blower to clean the external surfaces of the machine. Fold the machine and store it in the storage bag.

## TROUBLE SHOOTING

### Machine cannot start

POSSIBLE CAUSES	SOLUTION
Power circuit interruption	Check if the power socket is loose and ensure the voltage meets the standard requirements.
Switch malfunction	Check if the machine switch is turned on.
Worn-out carbon brushes	Replace the carbon brushes if they have reached the end of their lifespan (refer to the user manual for purchasing and replacement instructions).

### Sanding pad jumping

POSSIBLE CAUSES	SOLUTION
Excessive speed	Lower the speed setting.
Damaged or worn-out sanding pad	Replace the sanding pad (refer to the user manual for purchasing and replacement instructions).
Loose or misaligned sanding pad	Adjust the height of the sanding pad (refer to the user manual), keeping it within 2mm below the brush surface.

### Poor sanding performance

POSSIBLE CAUSES	SOLUTION
Incompatibility between sandpaper and wall surface	Choose high-quality sandpaper with an appropriate grit size based on the wall surface texture (refer to the user manual for sandpaper selection guide).
Overused sandpaper	Check the condition of the sandpaper surface and replace the sandpaper in a timely manner if the abrasive grains are worn.
Incorrect speed or pressure	Adjust the speed or pressure accordingly.
Interface pad is damaged or deformed	Replace the interface pad (refer to the user manual for purchasing and replacement instructions).



## Inadequate dust extraction

POSSIBLE CAUSES	SOLUTION
Suction power is set incorrectly	Adjust the suction power, increase it by rotating to the right.
Worn-out fan blades	Replace fan blades (contact customer support for assistance).
Sealing issues of the pre-assembled vacuum hose	Check the sealing of the pre-assembled vacuum hose and use tape to seal any leaks.
Insufficient built-in vacuum function power.	For large and rough surfaces, it is recommended to use an industrial vacuum cleaner, as the built-in vacuum function is more suitable for small and light sanding tasks.
Obstruction in the pre-assembled vacuum hose	Turn on the power switch and vacuum function without sanding to clear any debris or use a rod to unclog the hose.
Vacuum cleaner blockage	Use the self-emptying function of the vacuum cleaner to clear blockages or replace the HEPA filter.
Dust collection bag full	Regularly clean or replace the dust collection bag.

## Motor overheating

POSSIBLE CAUSES	SOLUTION
Excessive power load	Use lighter pressure during sanding.

## Difficulty in smooth movement during sanding

POSSIBLE CAUSES	SOLUTION
Incorrect suction power setting	When using a high-power vacuum cleaner, lower the suction power appropriately to avoid excessive suction.
Damaged or deformed interface pad	Replace the interface pad (refer to the user manual for purchasing and replacement instructions).
Slow sanding speed	Increase the sanding speed appropriately.

## LED light strip not working

POSSIBLE CAUSES	SOLUTION
Circuit issues with the light strip	Contact customer support for assistance.

If problems other than those listed occur, please feel free to contact us.

## WARRANTY

InoKraft warrants all equipment referenced in this document which is manufactured by InoKraft and bearing its name to be free from defects in material and workmanship on the date of sale to the original purchaser for use. With the exception of any special, extended, or limited warranty published by InoKraft, InoKraft will, for a period of twelve months from the date of sale, repair or replace any part of the equipment determined by InoKraft to be defective. This warranty applies only when the equipment is installed, operated and maintained in accordance with InoKraft's written recommendations.

This warranty does not cover, and InoKraft shall not be liable for general wear and tear, or any malfunction, damage or wear caused by faulty installation, misapplication, abrasion, corrosion, inadequate or improper maintenance, negligence, accident, tampering, or substitution of non-InoKraft component parts. Nor shall InoKraft be liable for malfunction, damage or wear caused by the incompatibility of equipment with structures, accessories, equipment or materials not supplied by InoKraft, or the improper design, manufacture, installation, operation or maintenance of structures, accessories, equipment or materials not supplied by InoKraft.

This warranty is conditioned upon the prepaid return of the equipment claimed to be defective to an authorized InoKraft distributor for verification of the claimed defect. If the claimed defect is verified, InoKraft will repair or replace with free of charge for any defective parts. If inspection of the equipment does not disclose any defect in material or workmanship, repairs will be made at a reasonable charge, which charges may include the costs of parts, labor, and transportation.

THIS WARRANTY IS EXCLUSIVE, AND IS IN LIEU OF ANY OTHER WARRANTIES, EXPRESS OR IMPLIED, INCLUDING BUT NOT LIMITED TO WARRANTY OF MERCHANTABILITY OR WARRANTY OF FITNESS FOR A PARTICULAR PURPOSE.

InoKraft's sole obligation and buyer's sole remedy for any breach of warranty shall be as set forth above. The buyer agrees that no other remedy (including, but not limited to, incidental or consequential damages for lost profits, lost sales, injury to person or property, or any other incidental or consequential loss) shall be available. Any action for breach of warranty must be brought within two (2) years of the date of sale.

InoKraft MAKES NO WARRANTY, AND DISCLAIMS ALL IMPLIED WARRANTIES OF MERCHANTABILITY AND FITNESS FOR A PARTICULAR PURPOSE, IN CONNECTION WITH ACCESSORIES, EQUIPMENT, MATERIALS OR COMPONENTS SOLD BUT NOT MANUFACTURED BY InoKraft. These items sold, but not manufactured by InoKraft (such as electric motors, switches, hose, etc.), are subject to the warranty, if any, of their manufacturer. InoKraft will provide purchasers with reasonable assistance in making any claim for breach of these warranties. In no event will InoKraft be liable for indirect, incidental, special or consequential damages resulting from InoKraft supplying equipment hereunder, or the furnishing, performance, or use of any products or other goods sold hereto, whether due to a breach of contract, breach of warranty, the negligence of InoKraft, or otherwise.