

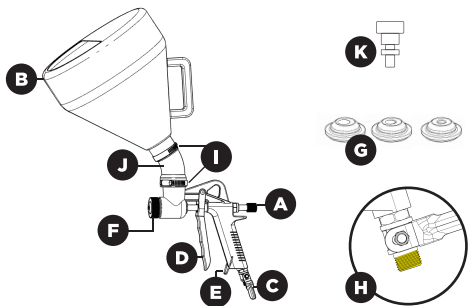

Scan the QR code for instruction video.

**KNOW YOUR SPRAY GUN**



<b>A</b>	Flow Rate Adjustment Knob
<b>B</b>	Hopper
<b>C</b>	Air Valve
<b>D</b>	Trigger
<b>E</b>	Trigger Lock
<b>F</b>	Nozzle Retainer
<b>G</b>	Nozzles (4mm, 6mm & 8mm)
<b>H</b>	Air Inlet
<b>I</b>	Hopper Clamp
<b>J</b>	Elbow hose
<b>K</b>	Air Hose Connector

**CHOOSE YOUR NOZZLE**

Application	Nozzle Size	Air Volume
Simulated Acoustic (Popcorn)	6mm (fine to medium) 8mm (coarse)	Medium to High
Orange Peel	4mm 6mm	Medium to High
Splatter Coat	6mm 8mm	Low to Medium
Knockdown	8mm	Low

**SET UP**

**Install Nozzle**

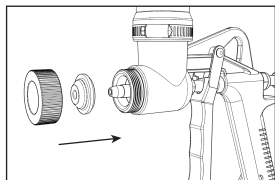

1. Install nozzle on front of gun and secure using retaining ring. Pull the trigger when installing the nozzle.

**Install Hopper**

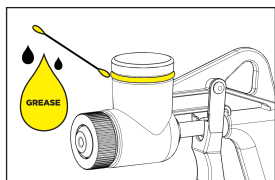

1. Apply some grease or any vegetable oil to o-ring to make attaching easier.

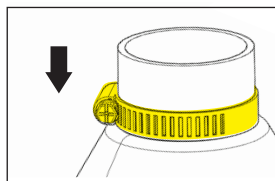

2. Place the hopper upside down. Slide clamp over hopper.

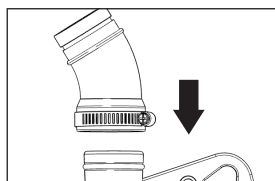

3. For ceilings, connect hopper and gun with the elbow hose. Put the bigger end of the hose to gun, and the smaller end to the hopper. Make sure both ends are **pushed to the bottom**.

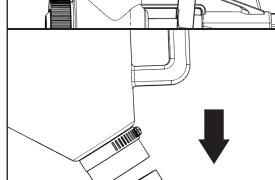

If not for spray ceilings, jump to step 5.

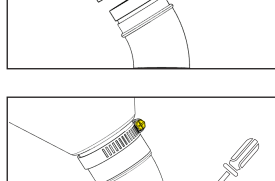

4. Tighten clamps on both ends of the hose.

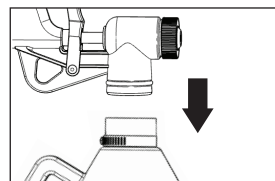

5. If not for spray ceilings, push gun down to the bottom, while slightly rotating.

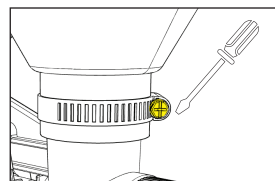

6. Tighten the hopper clamp with screwdriver.

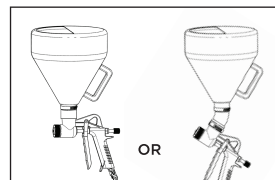

7. Check if the lid is tilted backward.

**NOTE:** Leaks may occur if hopper or hose is not pushed down to the bottom or clamp not tightened enough.

**Connect to Air Hose**

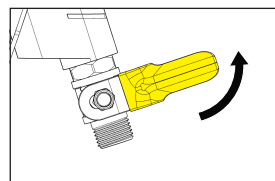

1. Make sure the air inlet valve is off.

**NOTE:** The air inlet valve controls the air flow. Close whenever needed.

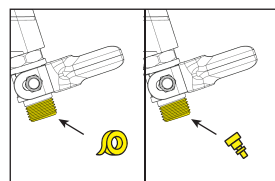

2. Wrap some raw tape over the air inlet may help enhance airtightness. Screw on the air hose connector to the air inlet.

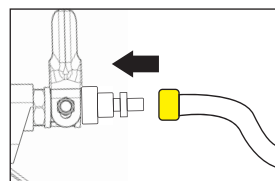

3. Connect air hose to the connector.

**OPERATIONS**

**NOTE:** Test spray pattern on cardboard first. Texture material should be fully mixed to avoid clogs.

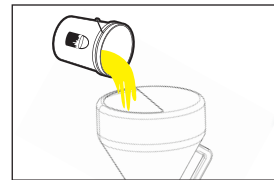

1. Fill hopper with prepared texture material.

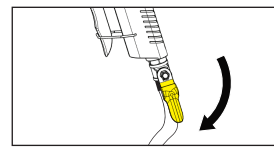

2. Turn on air compressor. Open the air inlet valve.

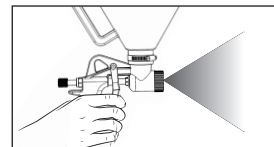

3. Pull the trigger to spray.

**NOTE:** The trigger only controls material flow, while the air inlet valve controls the air flow. Close whenever needed.

**Spray Techniques**

Test spray pattern on cardboard.

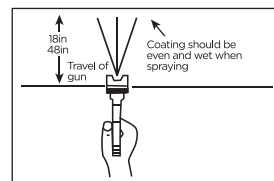

1. Hold gun 18 to 48 in. (45.7 to 122 cm) from surface.

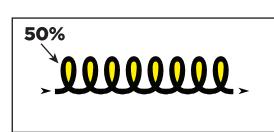

2. Overlap each stroke 50% in a circular motion.

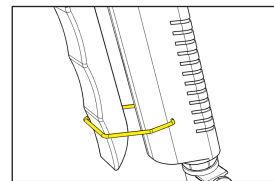

**FOR CONTINUOUS SPRAYING**  
Use trigger lock to hold trigger open and reduce fatigue

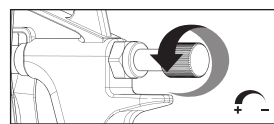

Adjust the **flow rate adjustment** knob and air volume for desired texture.

**FLOW RATE ADJUSTMENT KNOB:**

Turn clockwise to limit needle travel and reduce material flow; turn counterclockwise to increase needle travel and increase flow.

**For A FINE TEXTURE**

- Use thinner material mixture.
- Use smaller material nozzle.
- Decrease needle travel.

**For A HEAVY TEXTURE**

- Use heavier material mixture.
- Use a larger material nozzle.
- Increase needle travel.

**CLEAN & STORAGE**

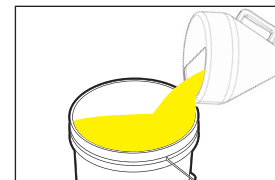

1. Drain remaining material.



2. Fill hopper with clean water.

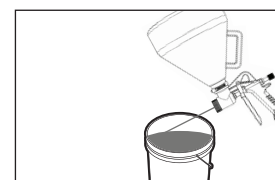

3. Trigger gun into bucket until most of texture mix is out of the hopper. Allow water to flow through gun until gun is clean.

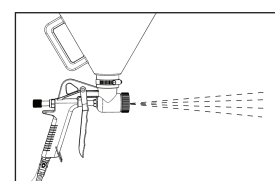

4. Open gun air inlet valve, allowing air through nozzle to clear out any remaining material.

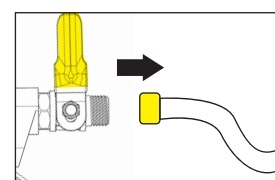

5. Close air inlet valve. Disconnect spray gun from air hose.

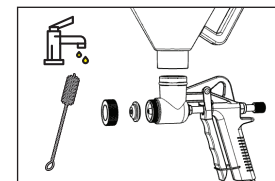

6. Remove hopper from gun and finish cleaning all components. A soft brush may be used to help loosen any dried material from the surface.

7. Connect air hose to gun. Open gun air flow valve to allow air flow through the needle to clear out remaining material.

8. If trigger feels sticky, lubricate needle seals.

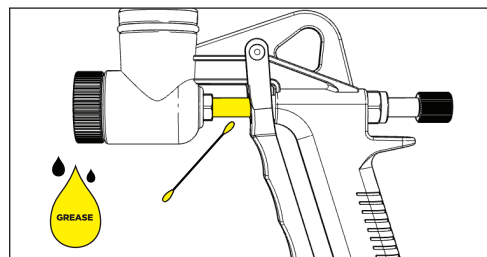

**QUICK TROUBLE SHOOTING**

**1. Leak at joints?**

If leak is between hopper and gun (or elbow hose), make sure that:

- Hopper pushed down to the bottom
  - O-ring flat without any bends or deformations
  - Clamp tightened around where the o-ring is located
- If air leaks from air hose connector, wrap raw tape over the air inlet.

**2. Not able to spray?**

Put finger on nozzle and pull the trigger to force clog out of hopper. Remove and clean all the components with warm soap water, reassemble and try again. Use thinner texture material or higher air pressure.

**PRODUCT INFORMATION**

Part Number	Product Description	Includes
IK01203001	TexCraft Texture Spray Gun Kit	<ul style="list-style-type: none"> <li>• TexCraft spray gun</li> <li>• Hopper</li> <li>• 4mm/6mm/8mm nozzle</li> <li>• Elbow hose</li> <li>• Clamps*2</li> <li>• Air hose connector</li> <li>• Texture Sponge</li> <li>• Knockdown Knife</li> <li>• Brush</li> </ul>

## SAFETY INSTRUCTIONS

### FIRE AND EXPLOSION

- Sparks and open flames are strictly prohibited. Paints can be highly flammable and can cause fire. Do not expose to open flames, electrical goods, cigarettes etc.
- Securely ground spray gun using conductive air hose. (Less than 11MΩ) Always ensure that the spray gun is earthed correctly.

### TOXIC FLUID OR FUMES HAZARD

- Toxic fluids or fumes can cause serious injury or death if splashed in the eyes or on skin, inhaled, or swallowed.
- Store hazardous fluid in approved containers, and dispose of it according to applicable guidelines.

### PROTECTION OF HUMAN BODY

- Use in a well-ventilated site, using a spray booth. Poor ventilation can cause organic solvent poisoning and fire.
- Always wear protective gear (safety glasses, mask, gloves) to avoid inflammation of eyes and skin. In case of any physical discomfort, immediately seek medical advice.
- Wear earplugs if necessary. Noise level can exceed 85 dB(A), depending on operating conditions and painting site.
- Pulling the trigger many times during operation, may cause carpall tunnel syndrome. Always rest, in case of tiredness.

### IMPROPER USE

- Never point gun towards people or animals.
- Never exceed maximum working pressure or maximum operating temperature.
- Always release air and fluid pressure before cleaning, disassembling or servicing. Otherwise, remaining pressure can cause bodily injury due to improper operation or scattering of cleaning liquid.
- Tip of fluid needle set has a sharp point. Do not touch the tip during maintenance to avoid accidents.
- Never use this gun to spray foods or chemicals. Otherwise, foreign substance, could cause corrosion of fluid passages which could adversely affect health.
- Never alter this spray gun, to avoid insufficient performance and damage.
- If something goes wrong, immediately stop operation and find the cause. Do not use again, until you have solved the problem.
- Do not enter working areas, where robots, reciprocators, etc. are used, until they have been turned off. Otherwise, they could cause injury.

## WARRANTY

### InoKraft Standard Limited Warranty

InoKraft warrants all equipment referenced in this document which is manufactured by InoKraft and bearing its name to be free from defects in material and workmanship on the date of sale to the original purchaser for use. With the exception of any special, extended, or limited warranty published by InoKraft, InoKraft will,

for a period of twelve months from the date of sale, repair or replace any part of the equipment determined by InoKraft to be defective. This warranty applies only when the equipment is installed, operated and maintained in accordance with InoKraft's written recommendations.

This warranty does not cover, and InoKraft shall not be liable for general wear and tear, or any malfunction, damage or wear caused by faulty installation, misapplication, abrasion, corrosion, inadequate or improper maintenance, negligence, accident, tampering, or substitution of non-InoKraft component parts. Nor shall InoKraft be liable for malfunction, damage or wear caused by the incompatibility of equipment with structures, accessories, equipment or materials not supplied by InoKraft, or the improper design, manufacture, installation, operation or maintenance of structures, accessories, equipment or materials not supplied by InoKraft.

This warranty is conditioned upon the prepaid return of the equipment claimed to be defective to an authorized InoKraft distributor for verification of the claimed defect. If the claimed defect is verified, InoKraft will repair or replace with free of charge for any defective parts. If inspection of the equipment does not disclose any defect in material or workmanship, repairs will be made at a reasonable charge, which charges may include the costs of parts, labor, and transportation.

**THIS WARRANTY IS EXCLUSIVE, AND IS IN LIEU OF ANY OTHER WARRANTIES, EXPRESS OR IMPLIED, INCLUDING BUT NOT LIMITED TO WARRANTY OF MERCHANTABILITY OR WARRANTY OF FITNESS FOR A PARTICULAR PURPOSE.**

InoKraft's sole obligation and buyer's sole remedy for any breach of warranty shall be as set forth above. The buyer agrees that no other remedy (including, but not limited to, incidental or consequential damages for lost profits, lost sales, injury to person or property, or any other incidental or consequential loss) shall be available. Any action for breach of warranty must be brought within two (2) years of the date of sale.

**InoKraft MAKES NO WARRANTY, AND DISCLAIMS ALL IMPLIED WARRANTIES OF MERCHANTABILITY AND FITNESS FOR A PARTICULAR PURPOSE, IN CONNECTION WITH ACCESSORIES, EQUIPMENT, MATERIALS OR COMPONENTS SOLD BUT NOT MANUFACTURED**

BY InoKraft. These items sold, but not manufactured by InoKraft (such as electric motors, switches, hose, etc.), are subject to the warranty, if any, of their manufacturer. InoKraft will provide purchasers with reasonable assistance in making any claim for breach of these warranties. In no event will InoKraft be liable for indirect, incidental, special or consequential damages resulting from InoKraft supplying equipment hereunder, or the furnishing, performance, or use of any products or other goods sold hereto, whether due to a breach of contract, breach of warranty, the negligence of InoKraft, or otherwise.

## Questions?

Don't hesitate to drop a message at [support@inokraft.com](mailto:support@inokraft.com)!

Join InoKraft Community for

- INSTRUCTION VIDEOS
- FREE TRIALS OF NEW PRODUCTS

by sending "I'm a kraftsman" and your purchase order ID to [support@inokraft.com](mailto:support@inokraft.com) or Scan:



Official Youtube  
[www.youtube.com/@inokraft](http://www.youtube.com/@inokraft)

Scan the QR code for instruction video.



 inokraft

 [support@inokraft.com](mailto:support@inokraft.com)

# INOKRAFT TEXCRAFT TEXTURE SPRAY GUN

## User Manual